

▶ NO NEED FOR SPECIAL TOOLS

a Main unit

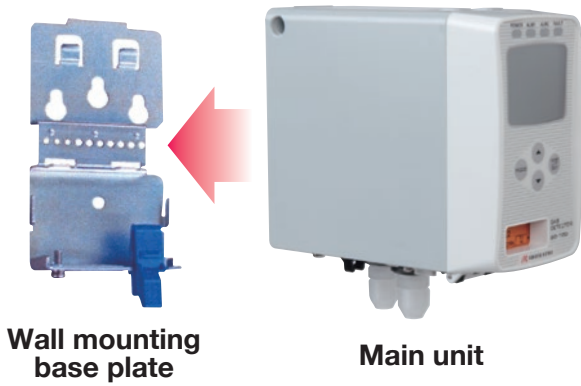

b Sensor unit

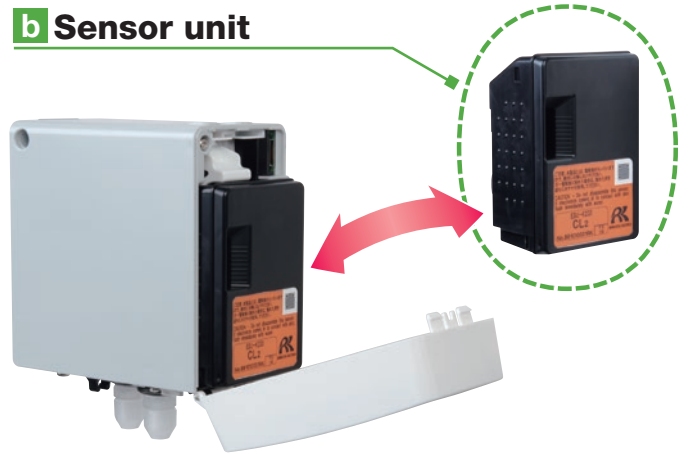

c Pump unit

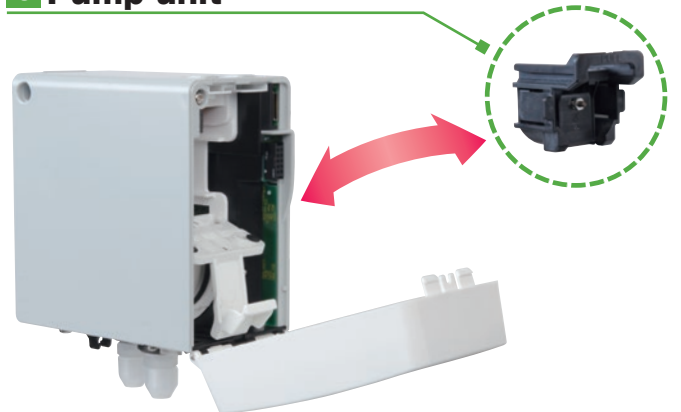

▶ SIMPLE UPGRADE FROM OLD UNITS TO OTHER COMMUNICATION METHODS (4-20mA or POE)

Dimensions for installation

The Installation space for GD-70D is the same as our old units.

Power requirements

Power requirements for GD-70D is DC24V, same as our old units.

Cable

The cable for the GD-70D is the same as one used for existing Riken units. You can use the existing cable installed for connecting to the GD-70D.

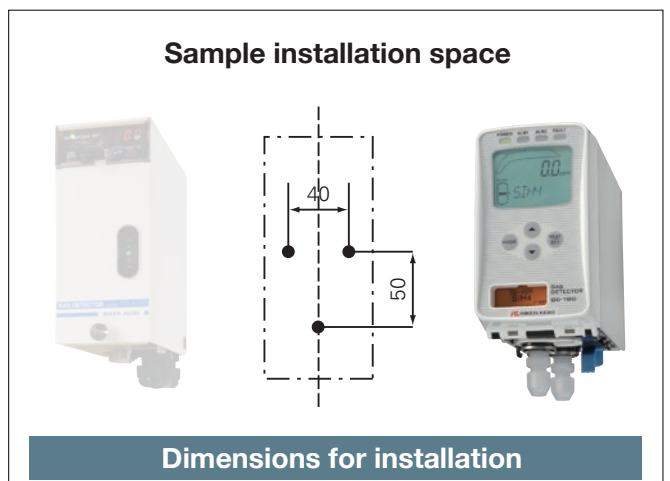
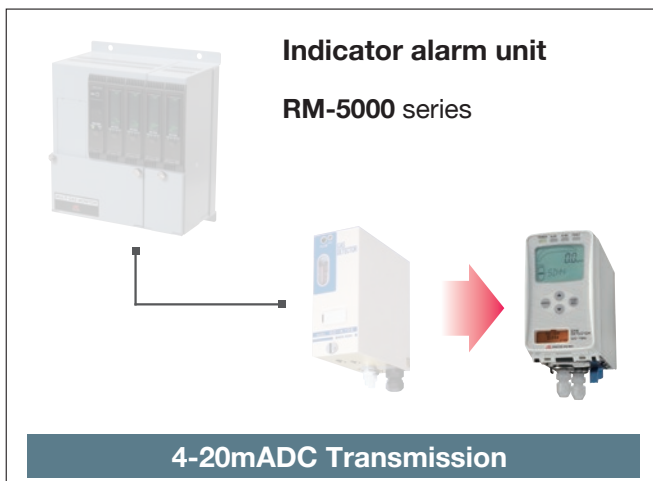

▶ COMPONENT DESIGNATIONS

Front view

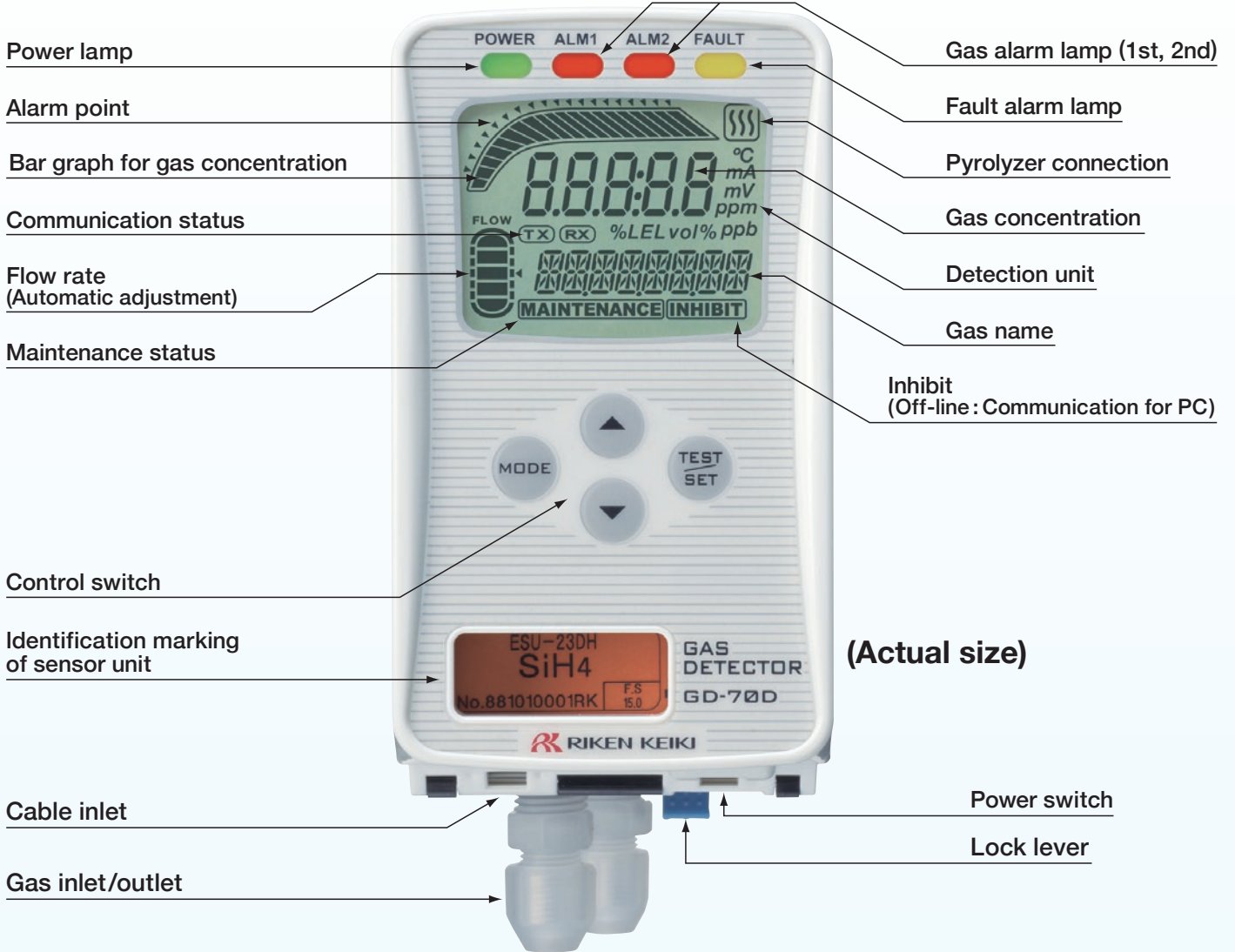

Front view



▶ INSTALLATION SPACE

Installation space can be saved.

